

**PARTIAL MAIN FLOOR PLAN - DEMOLITION**  
REFLECTED CEILING PLAN ALSO SHOWN FOR CLARITY  
SCALE: 1/8" = 1'-0"

**POWER AND SYSTEMS DEMOLITION NOTES:**

ALSO SEE NOTES & SPECIFICATIONS.  
REFER TO APPLICABLE RENOVATION DRAWING FOR RELOCATED COMPONENTS.  
ALL ABANDONED CABLES TO BE REMOVED AS REQUIRED BY LATEST CANADIAN ELECTRICAL CODE.  
DO NOT DISTURB OR DISCONNECT ANY WIRING & CABLING IN AREA OF WORK REQUIRED FOR OTHER AREAS.

1. REMOVE ALL COMPONENTS WITH DESIGNATION "D" BACK TO SOURCE, UNLESS OTHERWISE NOTED.
2. REMOVE & DISCONNECT ALL MECHANICAL EQUIPMENT (CONDUIT, WIRING, SUPPORTS, ELECTRICAL BOXES, STARTER, DISCONNECT, TIMER, RESET) BACK TO SOURCE - INCLUDING INTERLOCKS TO ASSOCIATE EQUIPMENTS.
3. EXISTING CEILING LUMINAIRES TO REMAIN, UNLESS OTHERWISE NOTED.
4. EXISTING LIGHT SWITCHES TO REMAIN, EXCEPT WALL MOUNTED LIGHT SWITCHES DESIGNATED FOR WALL DEMOLITION & BRANCH CIRCUIT CONNECTED TO NON-DEMOLITION AREA - CIRCUITS TO REMAIN & LIGHT SWITCH DEVICE BOX TO BE TEMPORARILY SUPPORTED.
5. REMOVE PAINT BOOTH LUMINAIRES & LIGHT SWITCH BACK TO SOURCE.
6. RELOCATE ELECTRIC HOT WATER HEATER CIRCUIT TO NEW LOCATION, SEE MECHANICAL DRAWING.
7. REMOVE ALL ELECTRICAL SURFACE MOUNTED COMPONENTS ON WALL BACK TO SOURCE IN AREA SHOWN, THERMOSTATS TO BE RELOCATED AS PER MECHANICAL DRAWINGS.
8. ALL FIRE DETECTION/PREVENTION DEVICES TO REMAIN (E.G., CEILING HEAT DETECTORS, SMOKE DETECTORS, FIRE ALARM PULL STATIONS, COMBINATION HORN STROBES, EMERGENCY LIGHTING).

HEATER SCHEDULE						
TAG	DESCRIPTION	MANUFACTURER	CATALOG No.	WATTS	VOLTIPL.	NOTES
BB-1	BASEBOARD	OUELLET	OFM1000	1000	208/204V	1, 2

HEATER SCHEDULE NOTES:  
1. WIRED TO WALL THERMOSTAT AS SHOWN FOR LOCAL TEMPERATURE CONTROL.  
2. APPROVED EQUAL IN ACCORDANCE WITH B7 - CHROMALOX, STELPRO, REZINOR

EMERGENCY SIGN AND LIGHTING SCHEDULE						
TAG	DESCRIPTION	MANUFACTURER	CATALOG No.	VOLTS	BRANCH CIRCUIT	
EBB-1	LED STEEL COMBO, SIGN & LED HEADS	AIMLITE	CXST12-2L	120V - 12V	ND46	
	DOUBLE REMOTE LAMP	AIMLITE	RMMB-2-12-3-7L-WHT	12V	ND46	

ABBREVIATIONS	
	DESCRIPTION
A	AMPERE, AMPACITY
AC	ABOVE COUNTER
ACT	ACOUSTIC CEILING TILE
AFF	ABOVE FINISH FLOOR
BFC	BELOW FINISH CEILING
CCT	CIRCUIT, CCT: C= PANEL "B"; CT= CIRCUIT "1" (B1)
CEC	CANADIAN ELECTRICAL CODE, LATEST EDITION
CLNG	CEILING
D	DEMOLITION, REMOVE BACK TO SOURCE
DED	DEDICATED CIRCUIT
DSW	DISCONNECT SWITCH
DWG	DRAWING
D/W	DISHWASHER
E	EXISTING OR "NO DESIGNATION"
GFCI	GROUND FAULT CIRCUIT INTERRUPTER
HTR	HEATER
HVAC	HEATING, VENTILATING AND AIR CONDITIONING
HZ	HERTZ
JB	JUNCTION BOX
M	METER
MD	MOTION DETECTOR
N	NEW
N.I.C.	NOT IN CONTRACT
NTS	NOT TO SCALE
OC	ON COUNTER
O/C	ON CENTER
OS	OCCUPANCY SENSOR
PNL	PANEL
R	RELOCATED LOCATION
RECPT.	RECEPTACLE
SW	SWITCH
TBD	TO BE DETERMINED
TYP.	TYPICAL
V	VOLT
W	WATT

LUMINAIRE AND SWITCH SCHEDULE				
TYPE	MANUFACTURER	CATALOGUE No.	LAMP	DESCRIPTION
(A)	(NEW) AIMLITE	P14LR-4-LA1-2-40K	LED 6600 LUMENS, 4000K	2'X4' LED ARCHITECTURAL IC PANEL - RECESSED - T-BAR, 60W, 120-270V
(B)	(NEW) LITHONIA	RAZ 24IN 30K 90CRI, RAZTRANS24 MVOLT, RAZ CC24, UCD JB, UC ERC24	LED 958 LUMENS, 3000K	MODULAR LED LIGHTING, 24" LENGTH, 24V TRANSFORMER - MULTI-VOLT POWER, 24" LINKING CORD, SPLICE BOX, 24" CONNECTOR CORD.
(OS)	(NEW) ACUITY	CMR 10D		CEILING MOUNTED OCCUPANCY PIR SENSOR WITH OCCUPANCY CONTROLLED DIMMING
(DIM)	(NEW) ACUITY	SPDMDRD WH		DIMMING SWITCHPOD, 0-10V, 120/277V, WHITE

ALL NEW LIGHTING LUMINAIRES AND COMPONENTS SHALL BE MANITOBA HYDRO POWER SMART APPROVED.

ELECTRICAL LEGEND	
TYPE	DESCRIPTION
(R)	DUPLEX RECEPTACLE
(H)	HEIGHT IN INCHES ABOVE FINISH FLOOR TO CENTERLINE OF DEVICE
(R2)	2-GANG DUPLEX RECEPTACLE
(R2U)	DUPLEX RECEPTACLE WITH (2) 2A USB 2.2 & 3.0 CAPABLE
(R2G)	GROUND FAULT CIRCUIT INTERRUPTER DUPLEX RECEPTACLE
(S)	LIGHT SWITCH, SINGLE POLE
(DSW)	DISCONNECT SWITCH
(JB)	JUNCTION BOX
(F)	FIRE ALARM MANUAL PULL STATION
(B)	FIRE ALARM BELL
(S)	FIRE ALARM STROBE SIREN
(H)	HEAT DETECTOR, CEILING RECESSED
(H)	HEAT DETECTOR, CEILING SURFACE MOUNT
(S)	PUBLIC ADDRESS SPEAKER
(S)	SPEAKER
(S)	SPEAKER
(S)	SPEAKER
(S)	SPEAKER VOLUME CONTROLLER
(D)	DATA PORT
(D)	FLOOR PEDESTAL DATA PORT
(V)	VOICE (PHONE) PORT: CENTREX LAND LINE
(K)	KEY PAD/DISPLAY - SECURITY
(H)	HORN - SECURITY
(M)	MOTION DETECTOR - SECURITY
(P)	ELECTRICAL PANEL
(T)	THERMOSTAT

ELECTRICAL DRAWINGS	
SHEET No:	SHEET TITLE
E1	PARTIAL MAIN FLOOR PLAN: ELECTRICAL; DEMOLITION, LEGENDS AND SCHEDULES
E2	PARTIAL MAIN FLOOR PLAN: ELECTRICAL; DEMOLITION (PHASE 2) AND RENOVATION
E3	ELECTRICAL SPECIFICATIONS

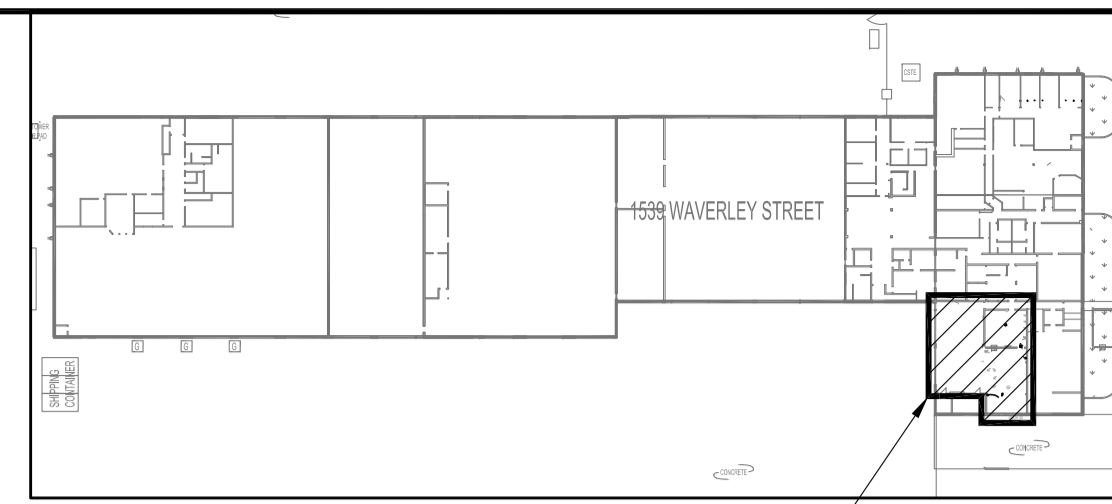

**KEY PLAN**  
SCALE: N.T.S.

AREA OF WORK

**NOTES:**  
THESE DRAWINGS SHALL NOT BE SCALED. CONSULT WITH THE CITY OF WINNIPEG AND CONTRACT ADMINISTRATOR ON ANY CONCERNS.  
ALSO REFER TO ELECTRICAL SPECIFICATIONS.  
SUBMISSION OF SITE MARKUPS, AS-BUILTS, OPERATING & MAINTENANCE MANUALS AND OTHER SUPPORTING DOCUMENTS TO THE CITY OF WINNIPEG ARE MANDATORY AT THE COMPLETION OF THIS PROJECT.  
THE CONTRACTOR SHALL VISIT THE SITE AND ENSURE ALL DIMENSIONS, DATUM, AND DETAILED INFORMATION SHOWN ARE CORRECT.  
THE CONTRACTOR IS TO REVIEW AND COORDINATE ALL ARCHITECTURAL, MECHANICAL AND ELECTRICAL DRAWINGS FOR ADDITIONAL OPENINGS THROUGH FLOORS, WALLS, AND CEILINGS FOR DUCTS, PIPES & ELECTRICAL RISERS AND ALL OPENINGS NOT SHOWN ON DRAWINGS.  
ALL OPENINGS THROUGH FIRE ASSEMBLIES INCLUDING FLOORS AND CEILINGS ARE TO BE FIRE STOPPED AND SEALED WITH ULC APPROVED FIRE STOPPING TO MAINTAIN THE INTEGRITY OF THE FIRE SEPARATION, AND PROVIDE A SMOKE-TIGHT BARRIER.  
ALL PRODUCTS AND MATERIALS TO BE USED AND INSTALLED SHALL CONFORM WITH MANUFACTURER'S SPECIFICATIONS, APPLICABLE CODES AND AUTHORITY HAVING JURISDICTION.  
THE CONTRACTOR SHALL BE RESPONSIBLE TO PATCH AND MAKE GOOD ALL EXISTING CONSTRUCTION AFFECTED BY THE REMOVAL OF ALL ITEMS FORMING PART OF THE RENOVATION WORK.  
ALL ABANDONED (KNOWN & UNKNOWN) ELECTRICAL FIXTURES, COMPONENTS, RECEPTACLES & DATA CABLING SHALL BE REMOVED BACK TO SOURCE & TERMINATED AS PER APPLICABLE CODES.  
RECONNECT & TEST ALL FIRE PREVENTION EQUIPMENT.  
**WARNING:**  
ASBESTOS MAYBE PRESENT BEHIND WALLS, CEILING SPACE & FLOORS. IF ASBESTOS & ANY HAZARDOUS MATERIAL IS FOUND, STOP WORK IMMEDIATELY & CONTACT CITY OF WINNIPEG, CENTRAL CONTROLS, PH: 204-986-2351.

No.	REVISION/DESCRIPTION	BY	DATE
0	ISSUED FOR CONSTRUCTION	DTA	2019 08.12



DRAWN	CHECKED	DESIGNED	APPROVED
DATE: 2018.12.06	USER APPROVAL		

THE CITY OF WINNIPEG  
PLANNING, PROPERTY AND DEVELOPMENT DEPARTMENT  
MUNICIPAL ACCOMMODATIONS DIVISION  
3-65 GARRY STREET, R3C 4K4

**PROJECT**  
PUBLIC WORKS SOUTH YARD  
RENOVATIONS TO ENLARGE PARKS VEHICLE STORAGE GARAGE  
1539 WAVERLEY STREET BID OPP: 944-2019

**SHEET TITLE**  
PARTIAL MAIN FLOOR PLAN  
ELECTRICAL  
DEMOLITION, LEGENDS AND SCHEDULES

SCALE	PROJECT No:	SHEET No:
AS SHOWN	2018-018	E1